

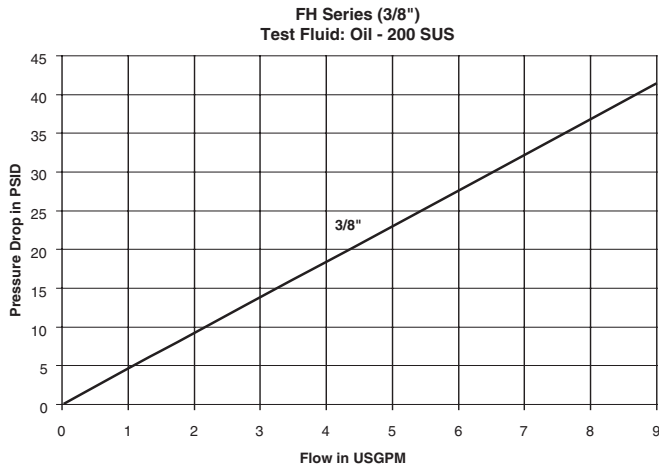

Description

Parker FH Series high pressure couplings are an innovative product combining the advantages of a flush-face design with a highly technical performance of a rated pressure of 10,000 PSI. For safety purposes, this product does not interchange with flush-face couplings having a lower pressure rating.

Performance



Features

- 10,000 PSI operating pressure (700 bar).
- Flush face, non-spill valving, both halves.
- Sleeve on coupler and nipple body have a RED finish for identification purposes.
- Simple Push-To-Connect operation.
- Sleeve-Lock to prevent accidental disconnect.
- Non interchangeable with low pressure flush face couplings.
- Meets performance and dimensional specifications of HTMA requirements, 10,000 PSI (700 bar).
- Anti Blow-Out Nitrile/PTFE bonded nipple seal.

Applications

- Hydraulic Crimpers, Cutters, Jacks, Benders, Clamps, Wedges
- Rescue Equipment
- High Pressure Test Equipment

Note: Protective dust plugs and caps play a crucial role in the life of a quick coupling and no purchase of a hydraulic quick coupling is complete without the selection of an appropriate dust plug and cap. See pages noted in Table of Contents for dust plugs and caps for the Parker full line of hydraulic couplings.

Materials of Construction

- Body:** Steel
- Finish:** Zinc Plated with yellow Chromate.
Sleeve and Nipple plated with Red Chromate.
- Valve:** Flush Face Valves
- Seal:** Anti blow-out Nitrile/PTFE bonded seal (nipple only)

Specifications

| Body Size (in.) | 3/8 |
|--|-----------------|
| Rated Pressure (PSI) | 10,000 |
| Rated Flow (GPM) | 6 |
| Temperature Range | -40° to +250° F |
| Spillage (ML) (max. per disconnect) | .020 |
| Air Inclusion (ML) (max. per connect) | .070 |

Hydraulic Quick Couplings

Non-Spill Couplings FH Series

Couplers

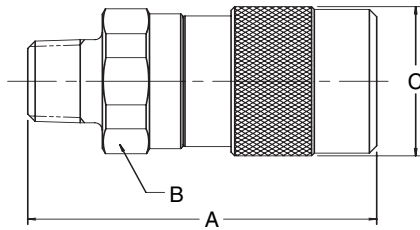

| Body Size (in.) | Part No. Steel | Thread Size | Overall Length | Wrench Flats | Dimensions (in.) | | Wt. (LB.) P/Piece |
|-----------------|----------------|--------------|----------------|--------------|------------------|------|-------------------|
| | | | | | A | B | |
| 3/8 | FH-371-6FP | 3/8 -18 NPTF | 2.63 | 1.12 | 1.23 | 0.44 | |
| 3/8 | FH-371-6MP | 3/8 -18 NPTF | 2.85 | 1.12 | 1.23 | 0.45 | |
| 3/8 | FH-371-6FB | G3/8 -BSPP | 2.55 | 1.12 | 1.23 | 0.45 | |

Nipples

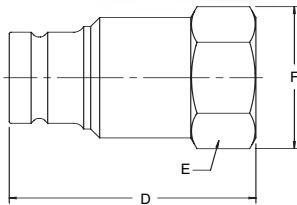

| Body Size (in.) | Part No. Steel | Thread Size | Overall Length | Wrench Flats | Dimensions (in.) | | Wt. (LB.) P/Piece |
|-----------------|----------------|-------------|----------------|--------------|------------------|------|-------------------|
| | | | | | D | E | |
| 3/8 | FH-372-6FP | 3/8-18 NPTF | 2.12 | 1.00 | 1.23 | 0.26 | |
| 3/8 | FH-372-6FB | G3/8 -BSPP | 2.12 | 1.00 | 1.23 | 0.28 | |

Standard Port Configurations

- FP** - Female Pipe Thread
- MP** - Male Pipe Thread
- FB** - Female British Standard Parallel